

VER	DESCRIPTION OF REVISIONS	DATE

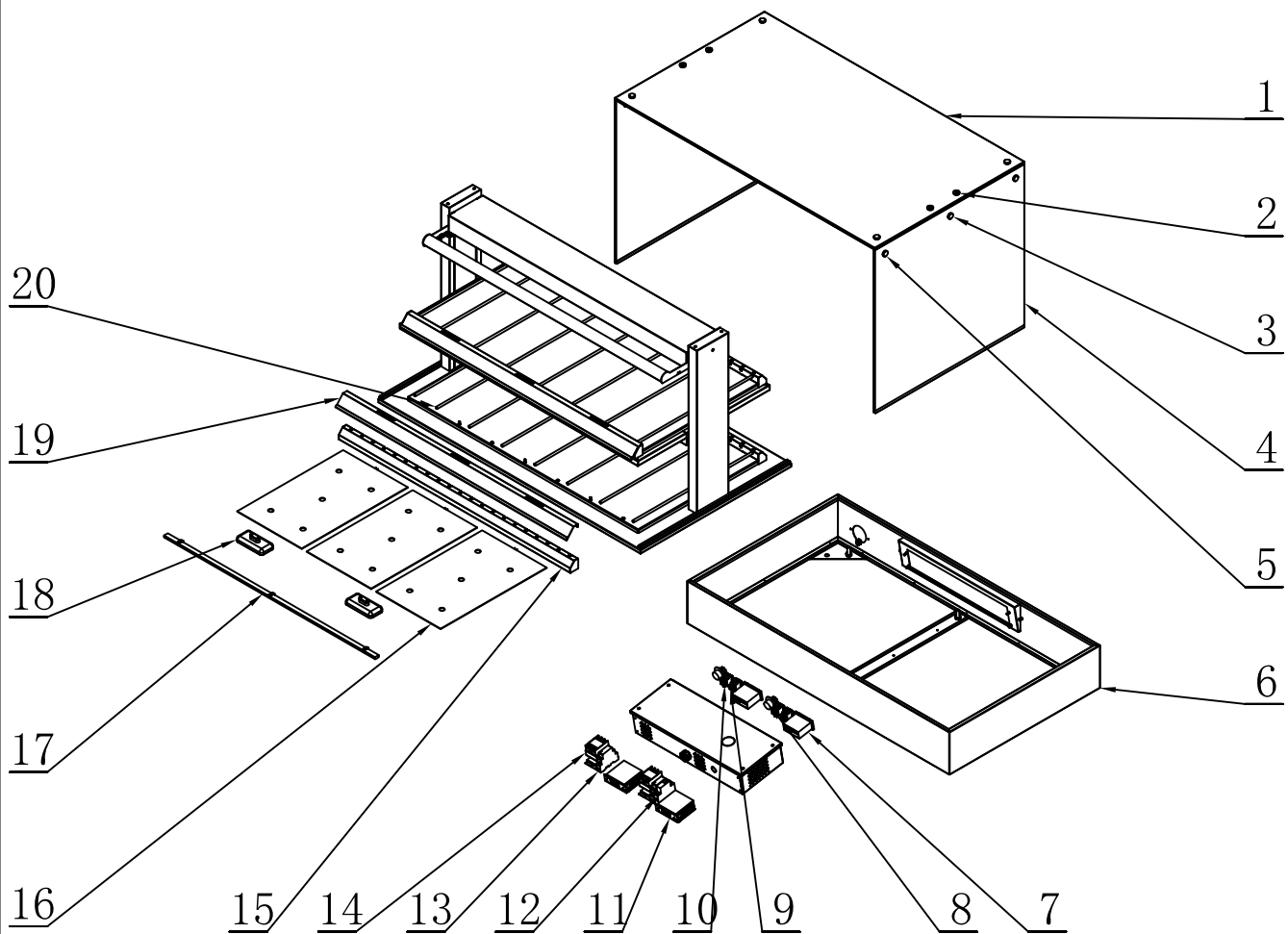

10301009 OTSHC12

ID	Part No.	Name	Spec	QTY	Note
1	30700637	Closed top glass		1	
2	30400133	Power supply	M5x22 (PHILLIPS)	4	
3	30400092	Power supply	M5*22	2	
4	30700355	Closed side glass		2	
5	30400091	Power supply	M5x16	8	
6	10307109	Base		1	
7	30100146	Thermostat	Dixell XR02CX 240V/50HZ	2	
8	30100412	Dimmer Switch	RV24YN20S-B504	2	
9	30100129	Lamp button	22A 125/250VAC, Yellow	2	
10	30100128	Power supply button	22A 125/250VAC, Green	2	
11	30101570	Power supply	RS-35-12 12V, 3A, 35W	2	
12	30100050	circuit breaker	DZ47-63 C20	1	
13	30100159	AC contactor	ICT 1NO 230~240V 25A	2	
14	30100233	Dimmer Module	10A/220-240V	2	
15	50201220	Barrier bracket		4	
16	30101420	Silicone Heater/Element	240V 145W	6	
17	30100477	LED Light	12V, L=965mm	2	
18	30100439	Ceramic Heater	HTS/2, 300W	4	
19	50201240	PRICE TAG	240V 145W	2	
20	30200778	Division bar		16	